

The Plumas 1845 s.f.

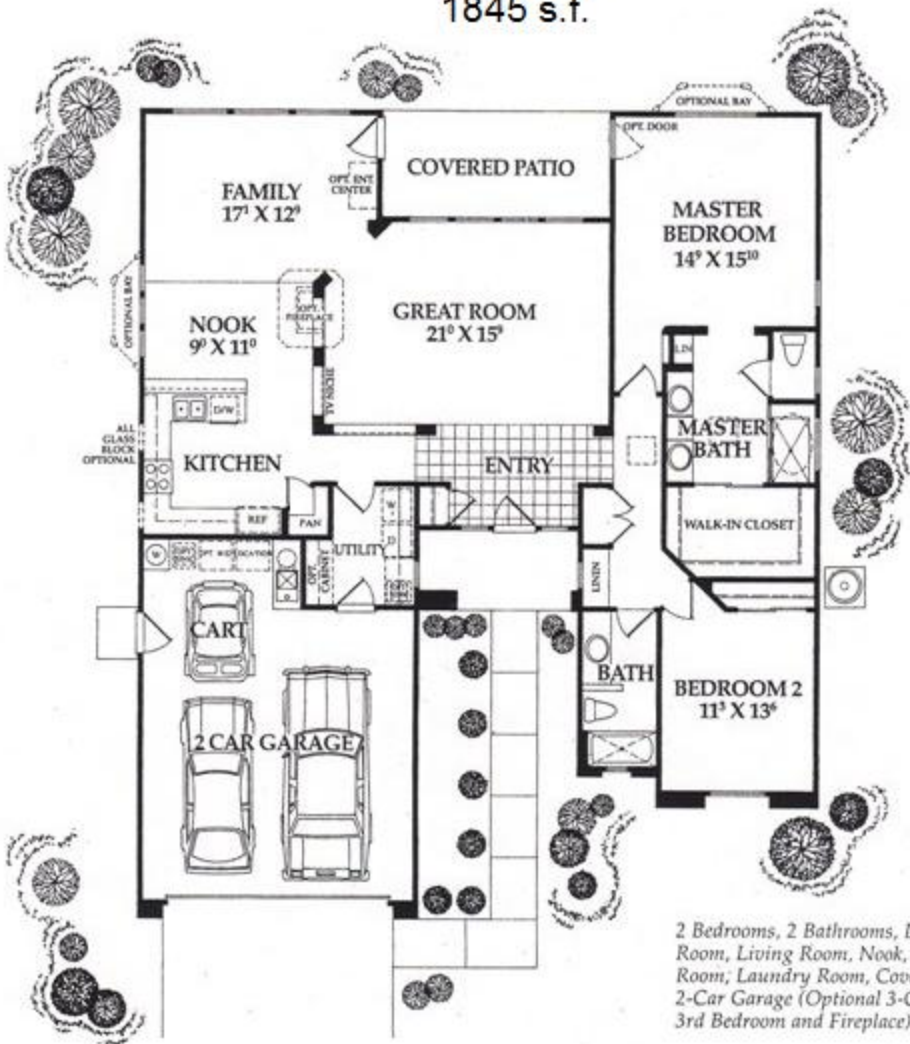

2 Bedrooms, 2 Bathrooms, Dining Room, Living Room, Nook, Family Room, Laundry Room, Covered Patio, 2-Car Garage (Optional 3-Car Garage, 3rd Bedroom and Fireplace)

COLDWELL BANKER SUN RIDGE REAL ESTATE
1500 Del Webb Blvd., Suite 101
Lincoln, CA 95648

office : (916) 543-5222
fax : (916) 543-5223

